

Technical Data

Applicable Syringe Size	2/3ml, 5/6ml, 10/12ml, 20ml, 30/35ml, 50/60ml	
Rate	2/3ml:0.01~160ml/h 10/12ml:0.01~800ml/h 30/35ml:0.01~2400ml/h	5/6ml:0.01~400ml/h 20ml:0.01~1600ml/h 50/60ml:0.01~3000ml/h
Bolus Rate & Volume	2/3ml:0.01~160ml/h 5/6ml:0.01~400ml/h 10/12ml:0.01~800ml/h 20ml:0.01~1600ml/h 30/35ml:0.01~2400ml/h 50/60ml:0.01~3000ml/h	0.1~2ml 0.1~5ml 0.1~10ml 0.1~20ml 0.1~30ml 0.1~50ml
FF Rate	2/3ml:0.01~160ml/h 10/12ml:0.01~800ml/h 30/35ml:0.01~2400ml/h	5/6ml:0.01~400ml/h 20ml:0.01~1600ml/h 50/60ml:0.01~3000ml/h
Manual KVO Rate & Volume	Rate: 0.01 ~ 30.0ml/h (0.01ml/h step) Volume: 2/3ml: 0.01~0.2ml 5/6ml: 0.01~0.2ml 10/12ml: 0.01~0.2ml 20ml: 0.01~0.5ml 30/35ml: 0.01~0.5ml 50/60ml: 0.01~1ml	
Rate Accuracy	Within ±2% (after calibration)	
Occlusion Pressure Levels	13 Levels are available	
Alarms Information	Infusion finished, near infusion end, VTBI completed, near VTBI end, Tubing falls off (optional), pre-occlusion alarm(optional), KVO completed, standby task completed, infusion is blocked, syringe falls off, syringe is improperly installed, forgotten operation, low battery, battery empty, abnormal running state, equipment failure, power failure, battery disconnected, etc.	
Prompts	Parameter overrun, infusion begins, AC power has been pulled out, speed overrun, Uncalibrated accuracy etc.	
Power source	100~240VAC, 50/60Hz. Internal rechargeable 11.1V Li battery with capacity≥2600mAh, After the new battery is fully charged, turn off wifi and set the screen brightness to "10", which allows the syringe pump to continuously operate at a rate of 5ml/h for 8 hours DC Input: 12.5-16V, Current:1A-0.6A	
Drug Library	Up to 6000 drugs are provided	
Dimensions	301mm(L)x183mm(W)x82mm(H)	



Sunfusion[®] Syringe Pump Semi-1|Erch-3|Anim-5



Scan for video

BYOND 比扬

Pioneer in Life Science

24 hour service hotline // +86 18674382266 (WeChat & WhatsApp)

Email: sale@csbeyond.com URL: www.hnbyond.com

Add: Beyond Zone, Lijiacun Rd, Xueshi Street, Yuelu District, 410208, Changsha, China



Sunfusion[®] Syringe Pump



Semi-1



Erch-3



Anim-5

Innovative design Better sensibility

> UI Design



- Brand-new appearance, small and lightweight, design as portable;
 - 3.5" colorful touchscreen to display various information on one page;
 - Easier operations are provided by simple UI design.

> High-quality PBT Enclosure



- High-quality PBT enclosure, which makes medical disinfection and cleaning convenient;
- Multi - and Across - combination of syringe pump and infusion pump is enabled by Slide guide and lock catch design, which is safe and practical.

Intelligent safety More care

> Fast Start

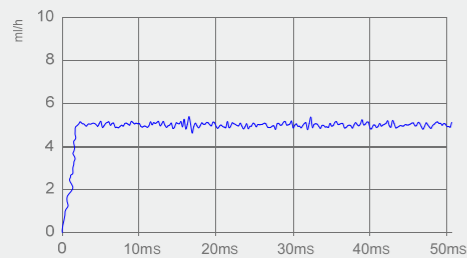

- 9 injection modes are able to satisfy various clinical needs;
 - Applicable to 2/3ml, 5/6ml, 10/12ml, 20ml, 30/35ml, 50ml /60ml syringes;
 - Rate are adjustable during running state.

> Dynamic Alarm Instructions

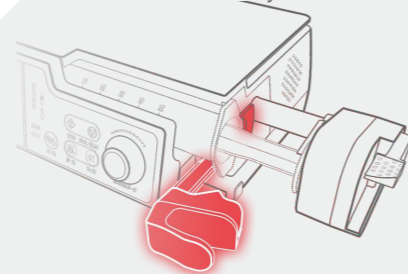

- 10 levels for forgotten operation time are selectable;
- 30 levels for near finished alarm time are optional to make supervision reliable;
- Intuitively demonstrate operation instructions by the application of Smart Alarm System.

> Multi-function interface



- DC Power connector;
- Multi-function connector;
- Compatible with either recommended syringes by default with great accuracy or other syringes by correct calibration. $\leq \pm 2\%$ accuracy is achieved.

$\leq \pm 2\%$

Precision

0.01ml/h
3000ml/h

Rate

IP24

High IP Level

13 Levels

DPS

Features



Auto-Lock Screen

Up to 14 levels time setting;
Prevention for operation errors.



Night Mode

Design for nighttime safe operation.



Dual CPU

Guarantee for safe work.



System Self-test

System self-test is conducted every time turning on, including alarm indicator, volume, pressure, air bubbles, etc;
Safeguard for every-time use.



Human Voice Alarm

Exclusive technology;
Combination of human voice, readable words and visual light alarm;
8 volume levels are available.



WLAN Function

Capable of communicating with information management system;
Remotely monitor patient's condition in real time.



History Record Cassette

Up to 50000pcs records, including operation, alarm and modification;
Trackable treatments are ensured.



Certification

Certified by TÜV Rheinland and EN ISO13485 : 2016

